



INNER CAM BEARING INSTALLATION DRIVER TOOL

J004936

2010-04-30

GENERAL

Kit Number

94107-09A

Models

Twin Cam models 2006 and earlier and Dyna 2005 and earlier (uses small end of bearing installer).

Twin Cam models 2007 and later and Dyna 2006 and later (uses large end of bearing installer).

WARNING

The rider's safety depends upon the correct installation of this kit. If the procedure is not within your capabilities or you do not have the correct tools, have a Harley-Davidson dealer perform the installation. Improper installation of this kit could result in death or serious injury. (00308a)

NOTE

A service manual for your model motorcycle is available from a Harley-Davidson Dealer.

Kit Contents

See [Figure 1](#) and [Table 1](#).

INSTALLATION

1. See [Figure 1](#) and [Table 1](#). Apply lubricant to the threads of screw (3) and thread into the cam bearing installer plate (1).
2. Thread the cam bearing driver tool (4) onto the screw (3).
3. Push the cam bearing installer (2) on the end of the cam bearing driver tool (4). Determine proper direction for installing early or late model bearing.
4. Place the new cam bearing with the numbers and letters facing the shoulder side of the cam bearing driver tool (4). Apply an assembly lubricant on the outside diameter of the bearing.
5. Align the assembled cam bearing installer plate over the crankcase flange in line with the bearing bores. Lubricate the four installer plate screws (6) and install the assembly to the crankcase flange.
6. Use a torque wrench set at 25 ft-lbs to turn in screw (3) carefully until the bearing starts into the bore. Tighten the screw until the torque wrench reaches the 25 ft-lbs. This will correctly locate the bearing below the case surface. Measure the distance from the top of the plate to the top of the bearing race. When you subtract the thickness of the installer plate (0.370 in.) the measurement should be greater than or equal to 3.10 in. Repeat the procedure for the next bearing.
7. When finished, remove the plate from the crankcase and store the four installer plate screws in the threaded holes in the center of the installer plate.

SERVICE PARTS

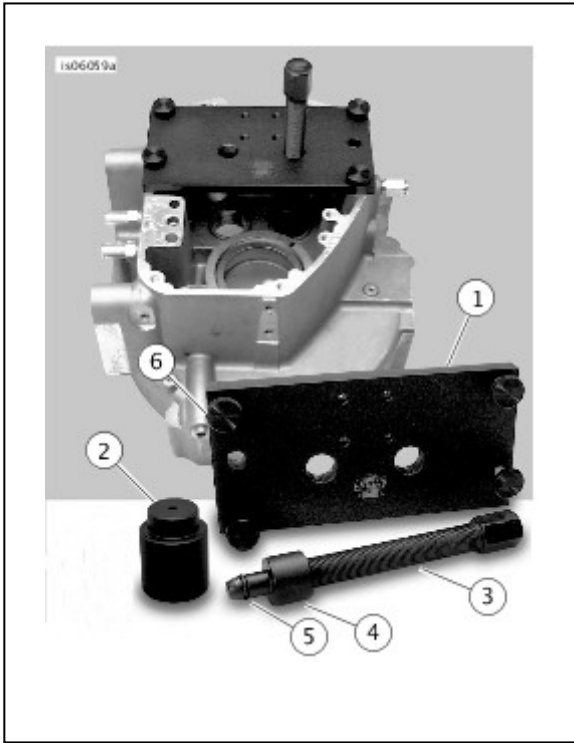

Figure 1. Service Parts: Inner Cam Bearing Installation Driver

Table 1. Service Parts

ITEM	DESCRIPTION (QUANTITY)	PART NUMBER
1	Installer plate, cam bearing	1278-1H
2	Installer, cam bearing	1278-3
3	Screw	1024H
4	Driver tool, cam bearing	2190H
5	Socket ring	2310
6	Screw, installer plate (4)	1213

If replacement parts are needed contact JIMS® at 805-482-6913 or www.jimsusa.com.